

HANGCHA GROUP CO., LTD.

Factory site: 666 Xiangfu Road,
Hangzhou, Zhejiang, China (311305)

Tel: +86-571-88926735 88926755
Fax: +86-571-88926789 88132890

sales@hcforklift.com www.hcforklift.com

HANGCHA GROUP CO., LTD. reserves the right to make any changes without notice concerning colors, equipment, or specifications detailed in this brochure, or to discontinue individual models. The colors of trucks, delivered may differ slightly from those in brochures.



Follow us on
Facebook



Follow us on
YouTube



Follow us on
WeChat



Download "Hangcha
Forklift" App



ISO45001:2018



ISO14001:2015



ISO9001:2015



HANGCHA trucks conform
to the European Safety
Requirements.



XA SERIES

MINI STACKER

With capacity of 1,200 to 1,500kg

XA SERIES ELECTRIC STACKER

The 1.2-1.5t XA Series Mini Stacker is a new-generation product newly developed by Hangcha for warehousing and logistics applications.

**Superior
Performance**

**UTILIZING ADVANCED
PERMANENT MAGNET
BRUSHLESS (PMB)
TECHNOLOGY**

**Comfortable
Operation**

**Low operating
and maintenance
costs**

**Reliability
and Safety**

Appearance

The XA Series Mini Stacker features professional industrial design aesthetics, inheriting the XA family design language with smooth, dynamic contours and compact dimensions. Ergonomic principles are thoroughly considered, aligning with the latest exterior design trends.

PERFORMANCE.

- Permanent Magnet Brushless (PMB) motor delivering high performance with low heat generation and low noise levels.
- PMB control system ensuring lower energy consumption

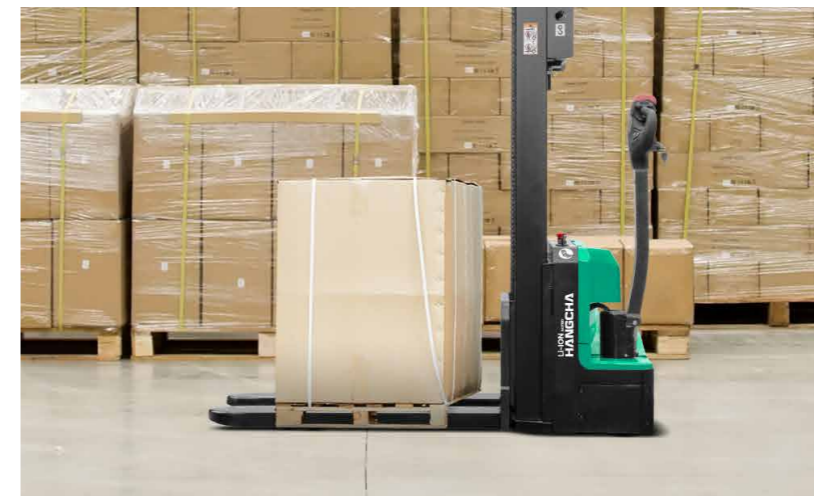

High efficiency

Powerful drive with 1.2/1.5t load capacity, meeting the handling requirements of most customers.



Intelligent

CAN bus control handle with standard LCD display for convenient fault diagnosis, integrated with key switch, card reader or password lock, offering rich functionality

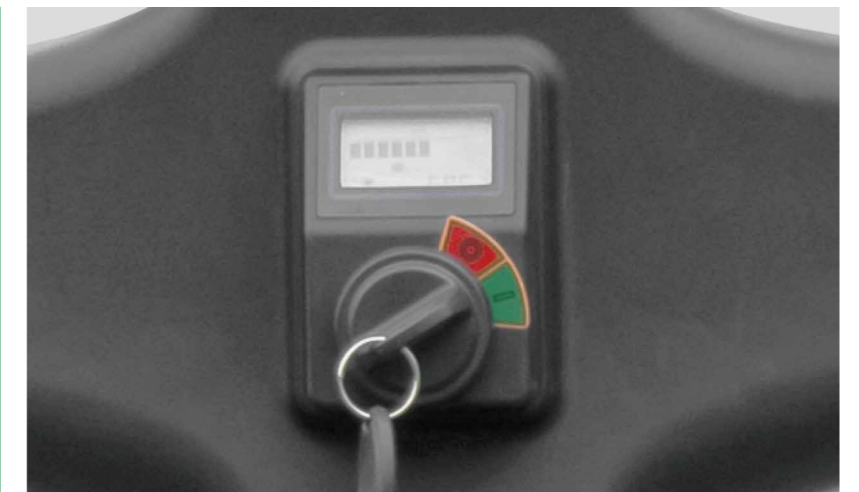

ENJOY YOUR WORK.

- Chassis constructed with high-strength steel plate frame structure, offering substantial residual load capacity and extended service life.
- Connectors from renowned brands with reliable protection for all wiring harnesses and cables, significantly improving electrical system reliability.
- Mature and stable hydraulic power unit featuring low noise, low vibration, and smooth, reliable lifting and lowering operations.
- Key switch equipped with standard dust cover, dustproof, waterproof and oil-resistant, greatly enhancing reliability in harsh operating conditions.



Stamp-formed forks providing superior strength and impact resistance, combined with fork tip guidance for enhanced operational efficiency.

Adjustable additional wheel height facilitating easier drive wheel load adjustment and anti-slip performance.



Hood and wheel covers manufactured from stamp-formed steel, enhancing component reliability.



Interlock switch utilizing non-contact proximity sensor for extremely high reliability.

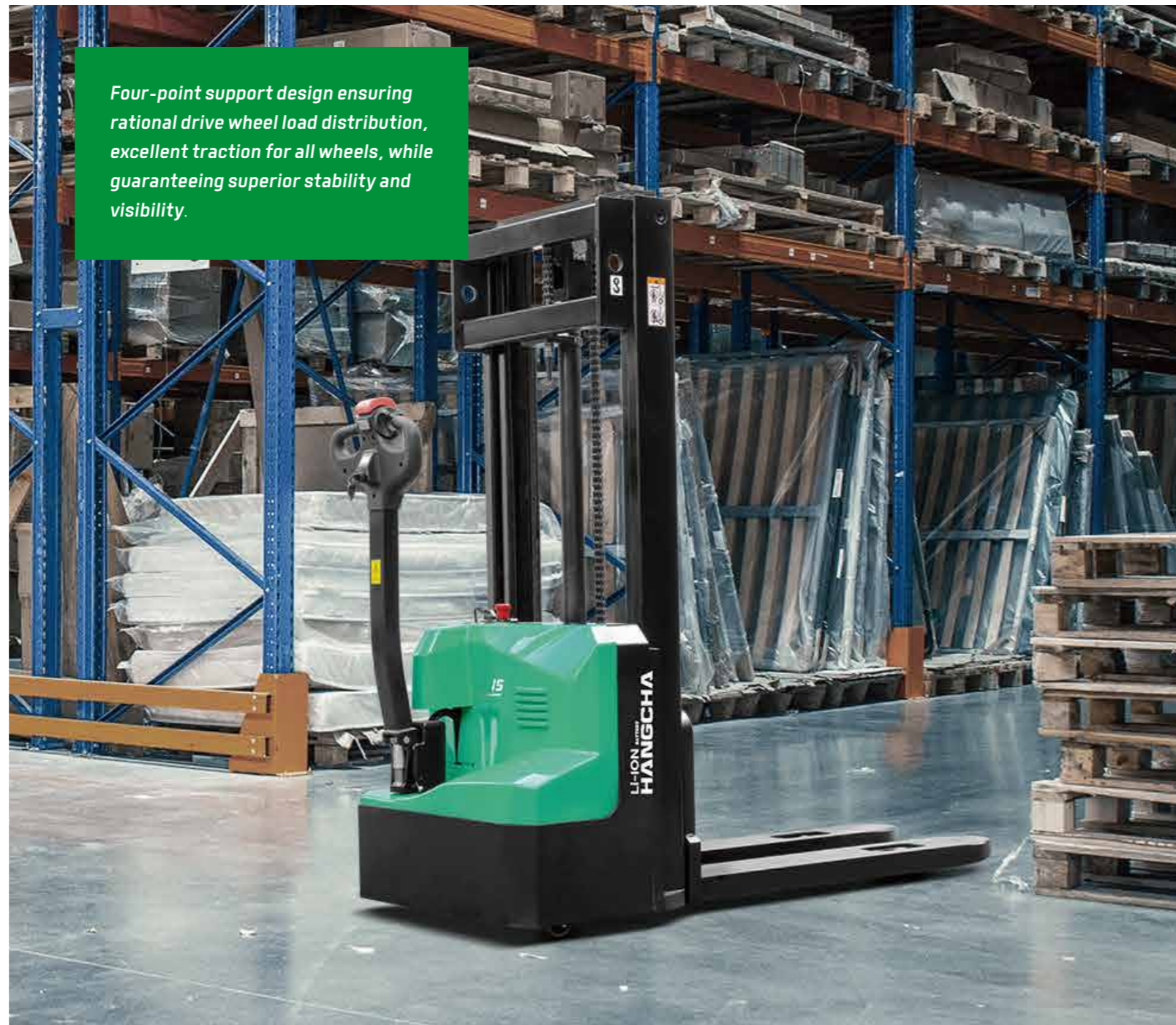
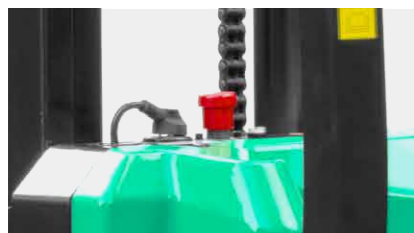

Four-point support design ensuring rational drive wheel load distribution, excellent traction for all wheels, while guaranteeing superior stability and visibility.

Standard soft landing automatically reducing lowering speed when forks are below a certain height from ground level, effectively protecting cargo safety.



Safety

- Release brake and emergency braking functions ensuring safe travel.
- Ramp anti-rollback function ensuring operational safety.
- Emergency reverse button located at the handle head effectively protecting the operator from injury when traveling backward in emergency situations.





HANGCHA provides Li-ion battery (LiFePO4) with 3 years or 6000 hours warranty.

**3 YEARS
WARRANTY**

Maintenance

- Permanent Magnet Brushless (PMB) motor requiring no maintenance.
- Drive side panel easily opened for more convenient motor removal and maintenance.
- All pivot pins fitted with lubricated bushings for easy maintenance and extended service life.



Rear hood easily removable for clear visibility of components, facilitating convenient maintenance and servicing of the entire machine.



Bolt-together mast design facilitating convenient maintenance.

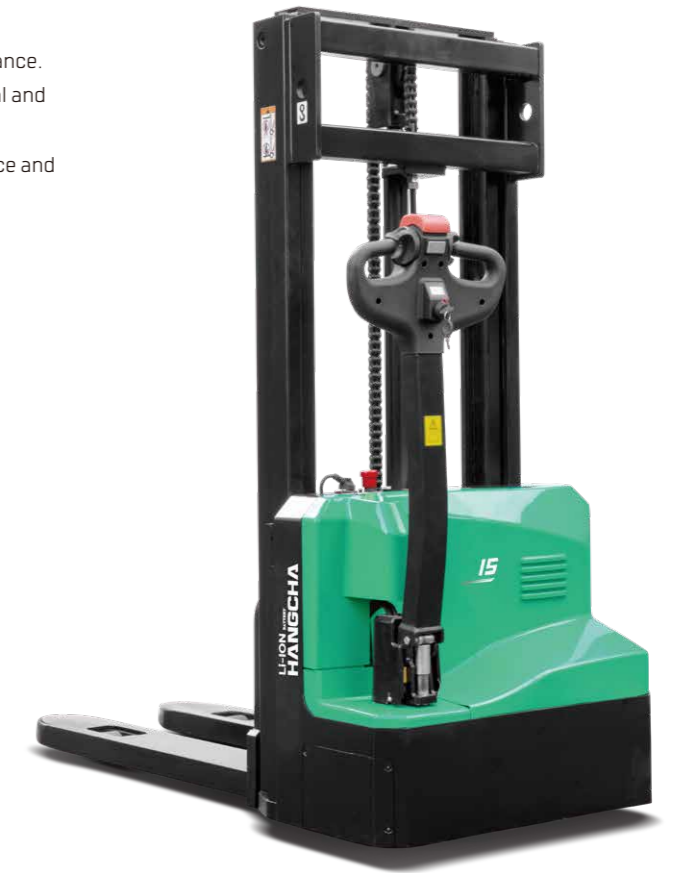

Features

Truck	Standard	Options
24V Permanent Magnet Brushless Motor	●	
Hydraulic Power Unit (HPU)	●	
Polyurethane Wheels	●	
Fork Length 1150mm	●	
Fork Length 1070mm for the straddle leg model	●	
Fork spread 680mm	●	
Fork spread 1310mm for the straddle leg model	●	
Fork Surface Ground Clearance 85mm	●	
Battery	●	
On-board Charger	●	
Height-Adjustable additional Wheels	●	
Dual Load Wheels	●	
Fork Length 1220mm		○
Proportional Lift		○
PC Guard		○
Universal Key Switch		○
Handle Depression Timing (Operator Presence Timing)		○
2.0-3.6m Lift height		○
1.75/2.0m Lift height for the single column model		○
Controls and instruments		
Controller	●	
Multi-function Handle with Key Switch and Display Instrument	●	
Safety		
Horn	●	
Emergency Disconnect Switch	●	
Electromagnetic Brake	●	
Left and Right Rear-view Mirrors		○

LITHIUM POWERED

EMPOWER YOURSELF
WITH THE BEST



Li
Lithium

POWER THE POSSIBILITIES
RELIABLE LITHIUM-ION TECHNOLOGY

LITHIUM BATTERY ADVANTAGES



Long service life

2000 full charging cycles with at least 75% residual capacity.



Return on investment

Add flexibility to your operation, cost-saving in the long term, increased efficiencies.



Maintenance free

No topping up of water or checking acid levels.



High energy density

The high energy density of the Li-Ion battery ensures long working times and increases the high availability.



Cold area application

Li-Ion batteries maintain high performance at temperatures below freezing.



High safety and reliability

Intelligent battery management monitoring every important function, no emission of battery gasses.



Opportunity charging

Full performance during several shifts thanks to effective interim charging.

FEATURES & BENEFITS THE HANGCHA DIFFERENCE

Efficiency

By quick opportunity charging any downtime, such as a lunch break, can be efficiently used and the battery is recharged in a very short period of time. Interim charging does not affect the battery service life.

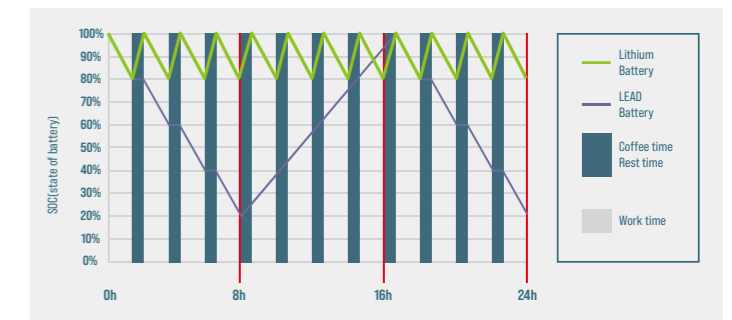

Safety

- / Intelligent battery management monitoring every important function.
- / Higher user safety, thanks to acid-free use.
- / User friendly due to avoided battery change.
- / No emission of battery gasses.

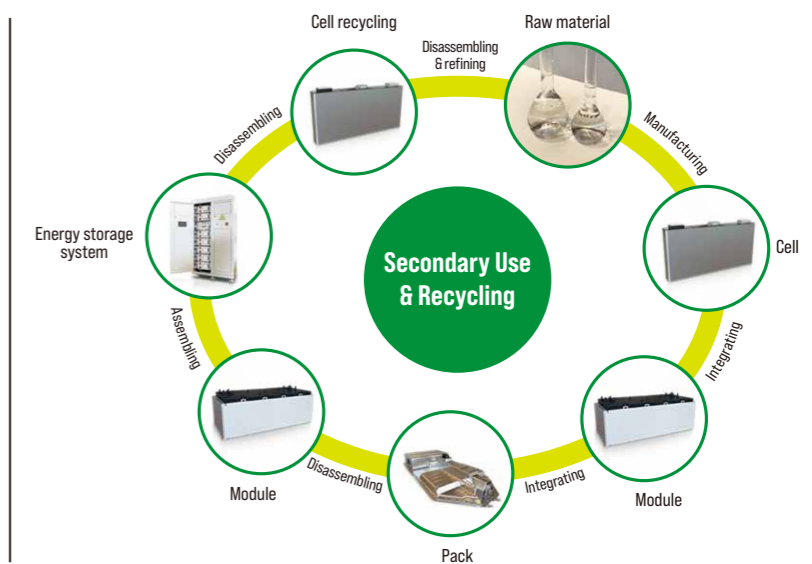

QUESTION 1

Q: What are the characteristics of lithium batteries, especially when used in high and low temperature environments?

Charging temperature: 0 C -55 C
Discharge temperature: -20 C -65 C
Storage environment temperature: -20 C -55 C

After the truck key switch is closed, the instrument battery condition needs to be checked:

1. Confirm that there is no battery system alarm message on the instrument panel.
2. Please check the remaining power before use. It is recommended to use the SOC between 50% and 100%.
3. If the SOC is lower than 20%, it is not recommended to continue using it. Please charge it as soon as possible.

QUESTION 2

Q: What is the charging time and usage time calculation of forklift lithium battery?

1. Available power of lithium battery (kWh) = rated voltage * rated power * 90% (To avoid over-discharge damaging the battery, the forklift is equipped with low power protection [less than 10%]).
 2. Charging time (h) = rated capacity of lithium battery (Ah) * 90% * charger output current (A).
 3. The power consumed for charging (kWh) = the available power of the lithium battery * 93% (the charging efficiency of the charger is calculated as 93%).
 4. Usage time (h) = available power of lithium battery * energy consumption data.
- For specific energy consumption values, please refer to the technical table on the sharing platform.**

QUESTION 3

Q: How does Hangcha BMS work to ensure the safety of the lithium battery?

HANGCHA BMS (battery management system) can monitor the cells at all times. As a result, hangcha lithium power is the reliable solution.



Battery Safety Management:

- Overcharge/over discharge protection
- Overcurrent/over-temperature/low-temperature protection
- Multi-level fault diagnosis protection
- Double fault monitoring



Battery Parameter Detection:

- Battery voltage detection and analysis
- Battery current detection and analysis
- Battery temperature detection and analysis



Equilibrium Management:

- Equalization based on voltage mode
- Equalization based on time mode
- Equalization based on battery cell SOC
- Active/passive equalization optional



Other Features:

- Low cost, low power consumption
- Historical data record
- Flexible cascade expansion
- CRC data validation

Technical data

		HANGCHA GROUP CO.,LTD.														
Distinguishing mark	1.1	Manufacturer (abbreviation)														
	1.2	Manufacturer's type designation	CDD12-XAMN11-ISZ	CDD15-XAMN11-ISZ	CDD12-XAMN11-SZ	CDD15-XAMN11-SZ	CDD12-XAMN11-I	CDD15-XAMN11-I	CDD12-XAMN11	CDD15-XAMN11	CTD12-XAMN11-ISZ	CTD15-XAMN11-ISZ	CTD12-XAMN11-SZ	CTD15-XAMN11-SZ		
	1.3	Drive: electric [battery type, mains, ...], diesel, petrol, fuel gas	Electric	Electric	Electric	Electric	Electric	Electric	Electric	Electric	Electric	Electric	Electric	Electric		
	1.4	Operator type: hand, pedestrian, standing, seated, order-picker	pedestrian	pedestrian	pedestrian	pedestrian	pedestrian	pedestrian	pedestrian	pedestrian	pedestrian	pedestrian	pedestrian	pedestrian		
	1.5	Rated capacity/rated load	kg	1200	1500	1200	1500	1200	1500	1200	1500	1200	1500	1200	1500	
	1.6	Load centre distance	c (mm)	600	600	600	600	600	600	600	600	600	600	600	600	
	1.8	Load distance, centre of drive axle to fork	x (mm)	790	790	790	790	790	790	790	790	735	735	735	735	
	1.9	Wheelbase	y (mm)	1213	1213	1213	1213	1193	1193	1193	1193	1213	1187	1213	1213	
	Weight	2.1	Service weight	kg	615	625	650	660	495	500	530	535	670	680	705	715
2.2		Axle loading, laden front/rear	kg	625/1190	750/1375	645/1205	770/1390	565/1130	625/1375	575/1155	635/1400	645/1225	770/1410	665/1240	790/1425	
2.3		Axle loading, unladen front/rear	kg	445/170	450/175	460/175	480/180	355/140	360/140	380/150	385/150	485/185	490/190	515/190	520/195	
Tyres, chassis	3.1	Tyres: solid rubber, superelastic, pneumatic, polyurethane		PU	PU	PU	PU	PU	PU	PU	PU	PU	PU	PU	PU	
	3.2	Tyre size, front		Ø210-70	Ø210-70	Ø210-70	Ø210-70	Ø210-70	Ø210-70	Ø210-70	Ø210-70	Ø210-70	Ø210-70	Ø210-70	Ø210-70	
	3.3	Tyre size, rear		Ø80-70	Ø80-70	Ø80-70	Ø80-70	Ø80-70	Ø80-70	Ø80-70	Ø80-70	Ø85-70	Ø85-70	Ø85-70	Ø85-70	
	3.4	Additional wheels (dimensions)		Ø80-64	Ø80-64	Ø80-64	Ø80-64	Ø80-64	Ø80-64	Ø80-64	Ø80-64	Ø80-64	Ø80-64	Ø80-64	Ø80-64	
	3.5	Wheels, number front/rear [• = driven wheels]		1•, 1/4	1•, 1/4	1•, 1/4	1•, 1/4	1•, 1/4	1•, 1/4	1•, 1/4	1•, 1/4	1•, 1/4	1•, 1/4	1•, 1/4	1•, 1/4	
	3.6	Tread, front	b10 (mm)	585	585	585	585	585	585	585	585	585	585	585	585	
	3.7	Tread, rear	b11 (mm)	520	520	520	520	520	520	520	520	520	1190	1190	1190	
Dimensions	4.2	Height, mast lowered	h1 (mm)	Sheet1	Sheet1	Sheet1	Sheet1	Sheet2	Sheet2	Sheet2	Sheet2	Sheet1	Sheet1	Sheet1	Sheet1	
	4.4	Lift	h3 (mm)	Sheet1	Sheet1	Sheet1	Sheet1	Sheet2	Sheet2	Sheet2	Sheet2	Sheet1	Sheet1	Sheet1	Sheet1	
	4.5	Height, mast extended	h4 (mm)	Sheet1	Sheet1	Sheet1	Sheet1	Sheet2	Sheet2	Sheet2	Sheet2	Sheet1	Sheet1	Sheet1	Sheet1	
	4.9	Height drawbar in driving position min./max.	h14 (mm)	890/1271	890/1271	890/1271	890/1271	890/1271	890/1271	890/1271	890/1271	890/1271	890/1271	890/1271	890/1271	
	4.15	Height, lowered	h13 (mm)	85	85	85	85	85	85	85	85	40	40	40	40	
	4.19	Overall length	l1 (mm)	1733	1733	1733	1733	1710	1710	1710	1710	1683	1683	1683	1683	
	4.20	Length to face of forks	l2 (mm)	583	583	583	583	560	560	560	560	583	583	583	583	
	4.21	Overall width	b1/b2 (mm)	820	820	820	820	820	820	820	820	820	820	820	820	820
	4.22	Fork dimensions DIN ISO 2331	s/e/l (mm)	60/170/1150	60/170/1150	60/170/1150	60/170/1150	60/170/1150	60/170/1150	60/170/1150	60/170/1150	35/100/1070	35/100/1070	35/100/1070	35/100/1070	
	4.25	Fork spread	b5 (mm)	680	680	680	680	680	680	680	680	790	790	790	790	
	4.32	Ground clearance, centre of wheelbase	m2 (mm)	25	25	25	25	25	25	25	25	40	40	40	40	
	4.34.1	Aisle width for pallets 1000 • 1200 crossways	Ast (mm)	2020 ¹⁾	2020 ¹⁾	2020 ¹⁾	2020 ¹⁾	2000 ¹⁾	2000 ¹⁾	2000 ¹⁾	2000 ¹⁾	1970 ³⁾	1970 ³⁾	1970 ³⁾	1970 ³⁾	
	4.34.2	Aisle width for pallets 800 • 1200 lengthways	Ast (mm)	2070 ³⁾	2070 ²⁾	2070 ³⁾	2070 ²⁾	2050 ²⁾	2050 ²⁾	2050 ²⁾	2050 ²⁾	1970 ⁴⁾	1970 ⁴⁾	1970 ⁴⁾	1970 ⁴⁾	
	4.35	Turning radius	Wa (mm)	1460	1460	1460	1460	1440	1440	1440	1440	1440	1440	1440	1440	1440
	Performance data	5.1	Travel speed, laden/unladen	km/h	4.2/4.5	4.2/4.5	4.2/4.5	4.2/4.5	4.2/4.5	4.2/4.5	4.2/4.5	4.2/4.5	4.2/4.5	4.2/4.5	4.2/4.5	4.2/4.5
5.2		Lift speed, laden/unladen	m/s	0.115/0.220	0.100/0.190	0.115/0.220	0.100/0.190	0.115/0.220	0.100/0.190	0.115/0.220	0.100/0.190	0.115/0.220	0.100/0.190	0.115/0.220	0.100/0.190	
5.3		Lowering speed, lade/unladen	m/s	0.120/0.125	0.135/0.130	0.120/0.125	0.135/0.130	0.120/0.125	0.135/0.130	0.120/0.125	0.135/0.130	0.120/0.125	0.135/0.130	0.120/0.125	0.135/0.130	
5.8		Max. gradeability, laden/unladen	%	6/10	6/10	6/10	6/10	6/10	6/10	6/10	6/10	6/10	6/10	6/10	6/10	6/10
5.10		Service brake		Regenerative	Regenerative	Regenerative	Regenerative	Regenerative	Regenerative	Regenerative	Regenerative	Regenerative	Regenerative	Regenerative	Regenerative	Regenerative
Electric-engine	6.1	Drive motor rating S2 60 min	kW	0.65	0.65	0.65	0.65	0.65	0.65	0.65	0.65	0.65	0.65	0.65	0.65	
	6.2	Lift motor rating at S3 15 %	kW	2.2	2.2	2.2	2.2	2.2	2.2	2.2	2.2	2.2	2.2	2.2	2.2	
	6.4	Battery voltage/nominal capacity	[V]/[Ah] or kWh	24/60	24/60	24/85	24/100	24/60	24/60	24/85	24/100	24/60	24/60	24/85	24/100	
	6.5	Battery weight	kg	17	17	25.8*2	26*2	17	17	25.8*2	26*2	17	17	25.8*2	26*2	

Note: 1) According to VDI2198 standard+276mm. 2)According to VDI2198 standard+163mm. 3)According to VDI2198 standard+335mm. 4)According to VDI2198 standard+335mm.

Sheet 1

Mast type	Max. lifting height h3	Ground clearance, fork [H-h3+h13]	Lowered height h1	Extended height h4	Free lift	Load capacity at 600mm	
						1.2t	1.5t
Duplex full-free wide view	mm	mm	mm	mm	mm	kg	kg
	1940	2025	1572	2592	0	1200	1500
	2440	2525	1772	2992	0	1200	1500
	2640	2725	1922	3292	0	1000	1200
	2940	3025	2072	3592	0	900	1000
3240	3325	2222	3892	0	750	800	
3540	3525	2322	4092	0	600	600	

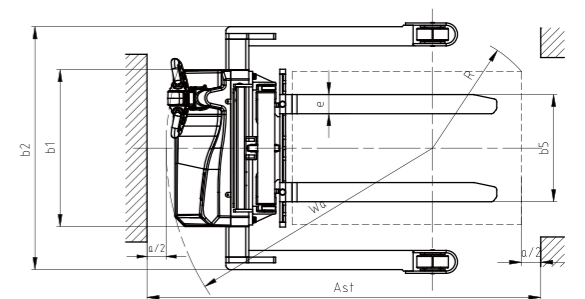
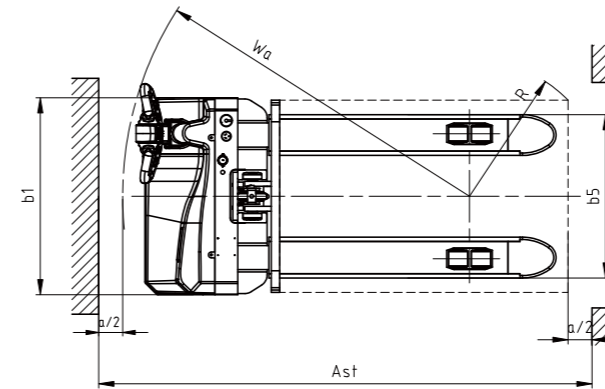
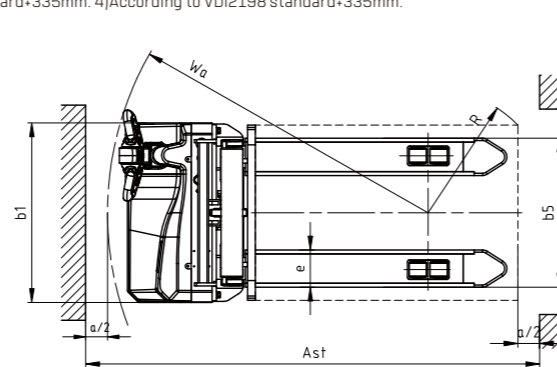

Sheet 2

Mast type	Max. lifting height h3	Ground clearance, fork [H-h3+h13]	Lowered height h1	Extended height h4	Free lift	Load capacity at 600mm	
						1.2t	1.5t
single cylinder single mast	mm	mm	mm	mm	mm	kg	kg
	1440	1500	1916	1916	0	1200	1500
	1690	1750	2041	2041	0	1200	1500
1940	2000	2166	2166	0	1200	1500	

